



Rotating Union

TYPE LRU-300

- ▶ Monoflow and duoflow design
- ▶ In-the-shaft mounted
- ▶ Self-supported rotating union
- ▶ Flanged housing or mounted with retaining plate
- ▶ Balanced mechanical seal
- ▶ Brass housing and elbow
- ▶ Stainless steel rotor and supply pipe
- ▶ Engineered sleeve bearing
- ▶ Full-media flow
- ▶ Easily field repairable

Operating Parameters

- ▶ Sizes d1 : 3/4" ... 1"
- ▶ Pressure p : 10 bar
- ▶ Temperature t : 120°C
- ▶ Speed v : up to 100 RPM

Seal Combinations

- ▶ Silicon Carbide/Silicon Carbide
- ▶ Tungsten Carbide/Ceramic

Applications

- ▶ General Chemicals
- ▶ Food & Beverages
- ▶ Textile
- ▶ Water

Monoflow Rotating Union

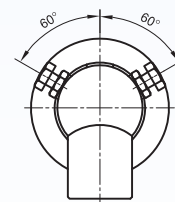
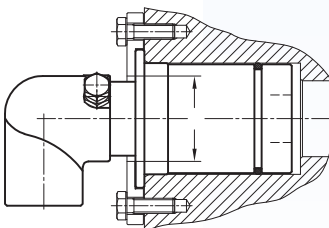

Duoflow Rotating Union

